

DC to AC Power inverter manual

HT-E-150FIT

Firstly, thank you for purchase our product.
Please read this manual carefully before installing or using this product.

With Europe, America, Japan Socket

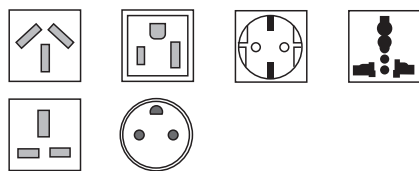

How to use it

Put the plug into the cigarette lighter hole in the car (DC12V).
turn on the power switch, LED indicator will be light up.
Then connect the electrical appliance to your inverter.

SPECIFICATIONS	
Model No.	HT-E-150FIT-12
OUTPUT	
Wave form	Modified Sine Wave
AC voltage	100V/120V/230V
output power	150W
Surge power	300W
Frequency	50/60Hz±3%
AC regulation	±8%
INPUT	
No load current draw	0.2A
DC voltage	12V
Voltage range	9.5~16VDC
Efficiency	>85%
DC connector	Cigar plug
PROTECTION	
Bat. Low alarm	NO
Bat. Low shutdown	9.5±0.5V
Over voltage	16±0.5V
Over Temperature	55°C ±5°C
Short circuit protection	Shut-off
Bat. Polarity Reverse	Fuse burn out
Over load	Re-start 2 times. Shut down if failed
ENVIRONMENT	
Working temp.	-15°C ~ 45°C
Working humidity	20%~90% RH non-condensing
Storage temp., Humidity	-30°C ~+70°C/-22°F~+158°F,10~95% RH
Temp. coefficient	±0.05%/°C(0~55°C)
OTHERS	
Dimension(LxWxH)	155x65x40mm
Net weight	0.27kgs

AVAILABLE APPLIANCES

It is suitable for the electrical appliance which consumption power is not excess 150W, like : TV set, Video, Radio, Fan, Karaoke, Power tool, Emergency illuminator... etc.

Maintenance

- Remember to pull all the plugs out of the socket when cleaning.
- Use dry cloth to clean the inverter. **CAUTION** : Do not wash it by water!

Storage & Placement

Place it in a cool and dry environment and avoid putting it under the sunshine.

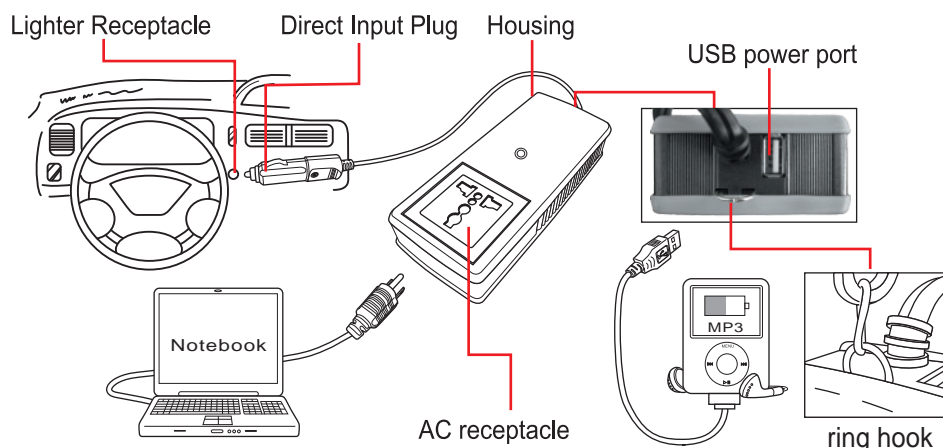

CAUTION

1. Please do not use if the power source is not DC12V, and make sure the polarity of the car is negative.

2. When you stop using it, please pull out the plug.



Due to the temperature of the metal part is still high, don't touch the plug by hand or place it near any flammable and easy-melting materials.

3. Under Voltage Protection system will be automatically shut off the inverter if the input voltage is too low. Please start your car engine to charge the battery, or stop using it.

4. Please pull out the plug from the cigarette lighter hole when starting the engine.

5. If the consumption power is over 150w when starting the tools, Over Load Protection system will be automatically shut off the inverter.



CAUTION

6. Due to the difference of the wave form, it may cause some buzzing and lines on audio and video equipment.

7. We recommend to use sine wave inverter on the sensitive test equipment.

8. Stop using the inverter if the power cord/plug has damaged or loosen.

9. Do not put any object into the inverter, it may cause fire, electric shock or short circuit, if there is any abnormal noise, smell or smoke, please turn it off immediately, then contact your retailer.

10. Do not place any heavy object on the inverter or the power cord. Do not use it when the power cord is in a coil or distorted.

11. Do not allow water drip or splash on the inverter. Do not touch the case or the plug by wet hand.

12. Do not attempt to remake the structure or the power cord, it may cause electric shock or fire, please contact your retailer for internal checking if it is necessary.

Troubleshooting

Problem	LED	Solution
Over load, Output short circuit	None	Reduce load/Solve short circuit situation
High input voltage protection (shut down)	None	Reduce input volts
Low input voltage warning	Blue flash	Change battery or recharge battery
Low voltage protection (shut down)	None	Change battery or recharge battery
Overtemperature protection (shut down)	None	Allow the inverter to cool. Reduce the load if continuous operation is required.