

200W Single Output PFC Series



- Universal AC input / full range
- PF>0.98@115VAC; >0.94@230VAC
- Built-in active PFC
- UL,TUV,CB,CE,CCC approved (refer to spec. of each series)
- Protections: overload/ over voltage/ short circuit/ over temperature
- Built in fan speed control
- 5 years limited warranty
- F620C 199 × 99 × 50(mm)

AC input voltage range	85~264VAC (120~370VDC)
Input frequency	47~63Hz
Inrush current	cold start, 20A/115VAC, 40A/230VAC
Input leakage current	< 1mA/ 230VAC
Line regulation (full load)	≤ ± 0.5%
Output voltage adjust range	± 10%
Output overload protection	105~150%, current limiting, auto recovery
Output over voltage protection	115~150%, shut off, re-power on to recover
Withstand voltage	I/P -O/P: 3.0KVAC/1min I/P -F/G: 1.5KVAC/1min O/P-F/G: 0.5KVAC/1min
Rise time	50ms@full load (typical)
Hold up time	20ms@full load (typical)
Operating temperature	-20℃~+70℃ (refer to the derating curve)
Safety standards	GB4943, UL60950, EN60950
EMC standards	GB9254, EN55022 classB, EN55024, EN61000-3-2,3, EN61000-4-2,3,4,5,6,8,11
Cooling method	fan
Weight & packing	0.81kg/pcs, 20pcs/CTN

Model	DC Output		Load regul.	R&N	Efficiency
HF200W-SC-3.3	3.3V	40.0A	0.5%	100mV	70%
HF200W-SC-5	5V	40.0A	0.5%	100mV	76%
HF200W-SC-7.5	7.5V	26.7A	0.5%	100mV	80%
HF200W-SC-12	12V	16.7A	0.5%	120mV	81%
HF200W-SC-13.5	13.5V	15.0A	0.5%	120mV	82%
HF200W-SC-15	15V	13.5A	0.5%	120mV	83%
HF200W-SC-24	24V	8.4A	0.5%	150mV	84%
HF200W-SC-48	48V	4.2A	0.5%	150mV	85%

* 3~48VDC output all available.

Drawing

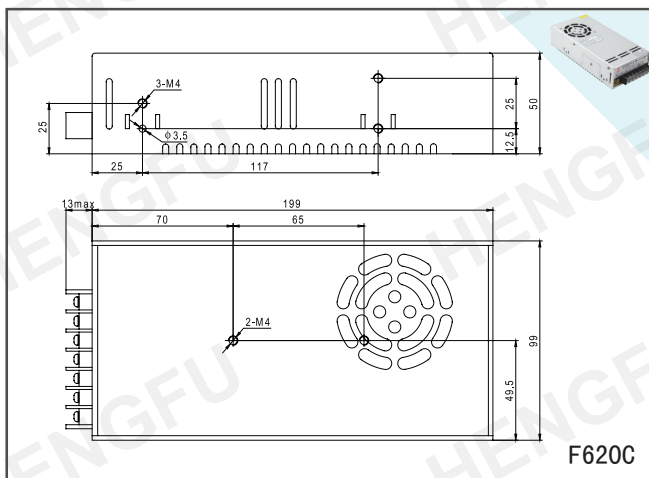

F620C